

INSTALLATION GUIDE

Last updated on 8 Nov 2024

LUMINO Accessories

SPIGOT ADAPTOR

Suitable for spigot sizes 60-76mm (Black)

Compatible with both the LUMINO and LUMINO PRO ranges.

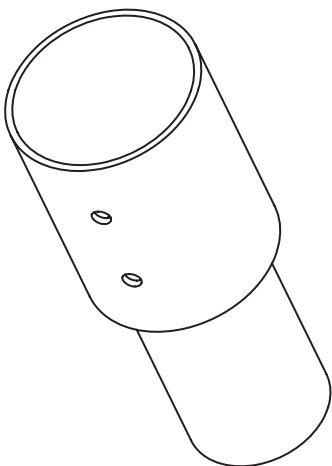

M8*25 set screws - 2pcs



M8*25 nuts- 2pcs

Product code

HSSA6076

Spigot adaptor- 1pcs

Spigot Adaptor Installation Guide

Preparation Before Installation

Safety First: Ensure the power to the lamp is turned off and disconnected.

Tools Required:

Allen wrench

M8 hex nut wrench

Step-by-Step Installation

Step 1: Carefully read all instructions before beginning the installation process.

Step 2: Check that all required materials and tools are available.

Step 3: Insert the larger end of the spigot adaptor into the lamp pole. The adaptor is compatible with lamp pole diameters ranging from 60-76mm.

Step 4: Align the adaptor screw holes, then secure it in place by screwing in the set screws and attaching the nuts.

Step 5: Tighten the set screws using the Allen wrench. Secure the nuts with the M8 hex nut wrench to ensure a firm fit.

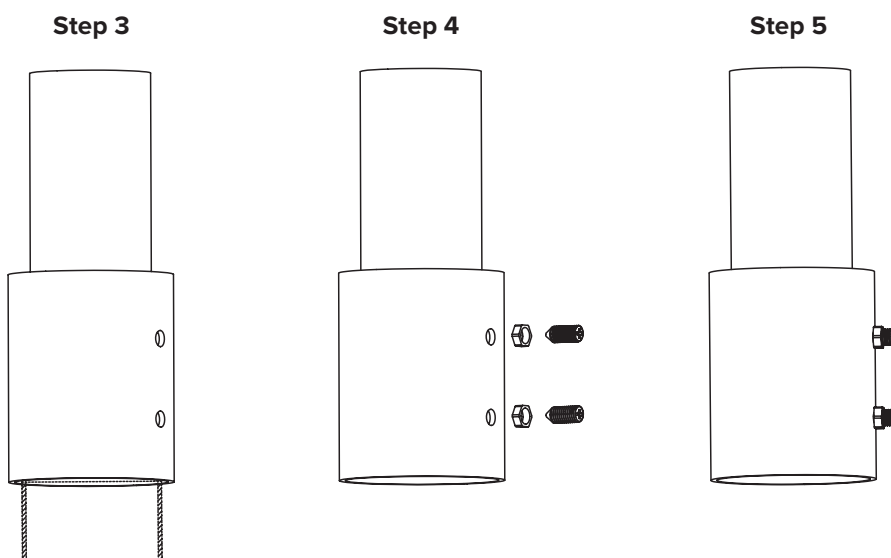

SERVICE CONTACT:



HANECO

Haneco Lighting Australia Pty Ltd
262 Marion Road, Netley, South Australia 5037
Haneco.com.au
1300 001 533